

First Floor Plans

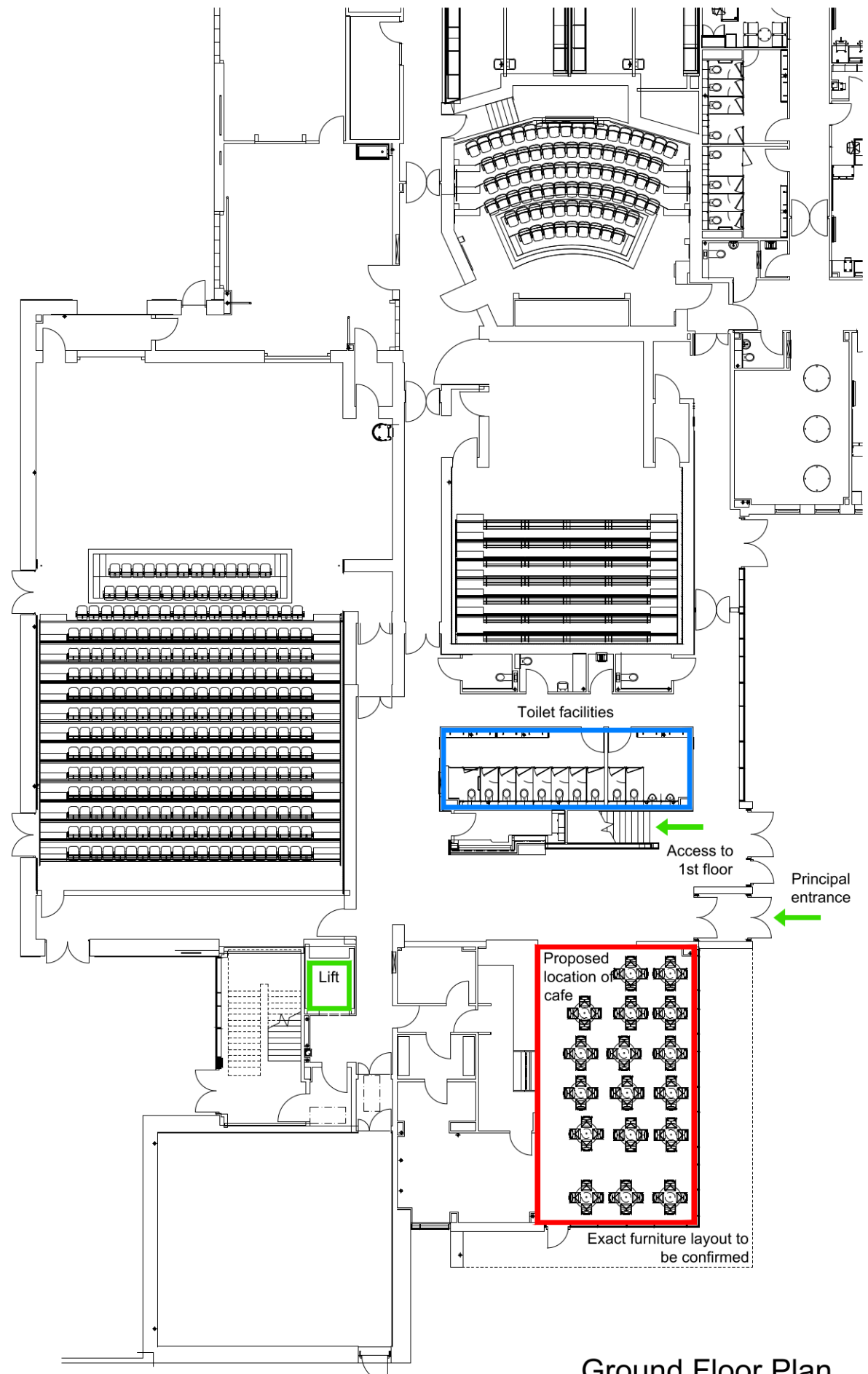

Ground Floor Plans

For detailed layout refer to drawing AL (03) 002

Letter	Date	Contents
REVISIONS		

## Information

**Asset & Procurement Solutions  
Enterprise & Communities**



North Lanarkshire Council  
Civic Centre,  
Windmillhill Street,  
Motherwell,  
ML1 1AB.

Job Title  
**Hub Integration  
Phase 1**

Drawing Title  
**Cumbernauld Academy  
Ground & first floor plans**

Job no. XX XX XX XXX	Drawn RJ
Drawing no. AL (03) 001	Scale nts
Rev. -	Date Sept. '21

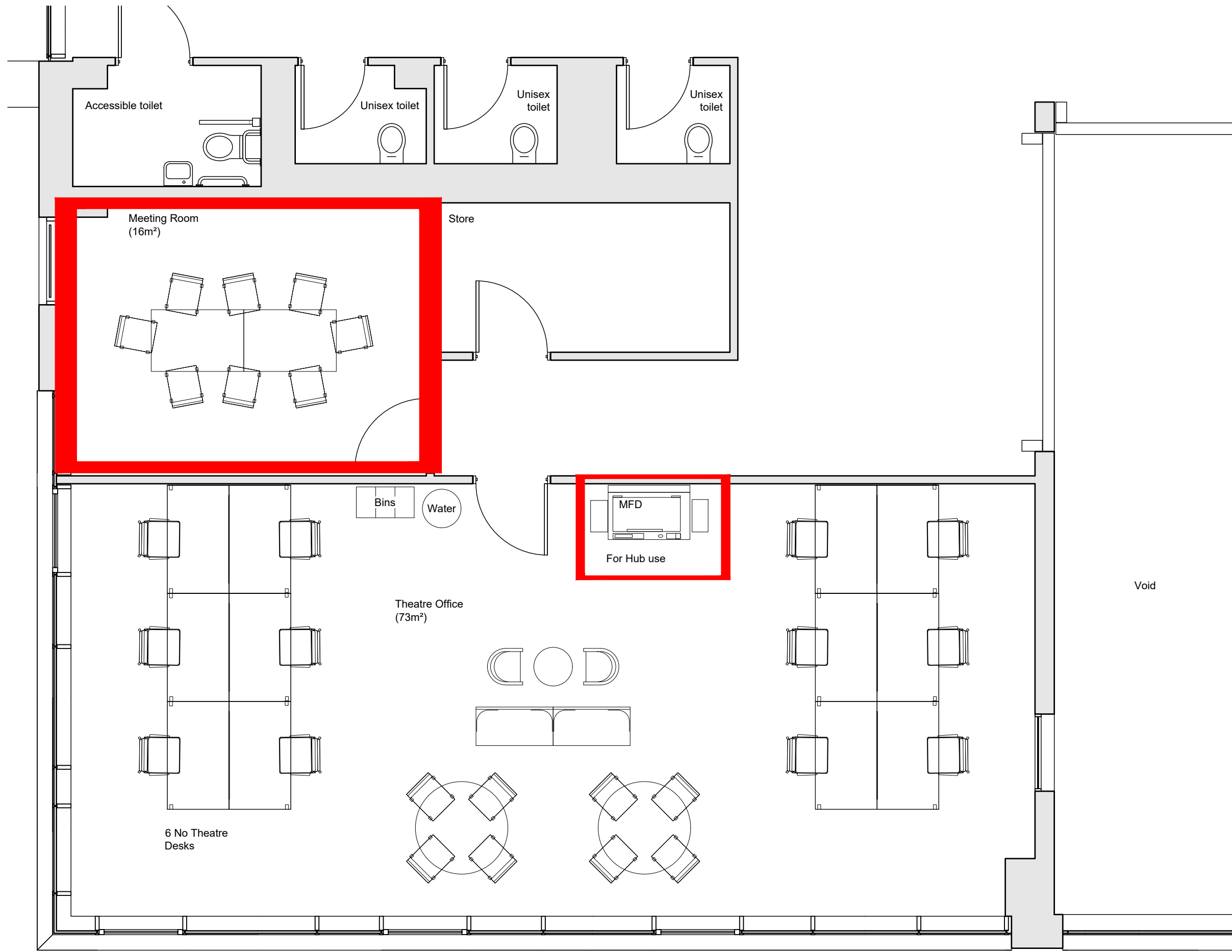

For location refer to drawing AL (03) 001

Furniture Layout  
1:50

Letter	Date	Contents
REVISIONS		

## Information

**Asset & Procurement Solutions  
Enterprise & Communities**



North Lanarkshire Council  
Civic Centre,  
Windmillhill Street,  
Motherwell,  
ML1 1AB.

Job Title  
**Hub Integration  
Phase 1**

Drawing Title  
**Cumbernauld Academy  
First floor plan  
As proposed**

Job no. XX XX XX XXX	Drawn RJ
Drawing no. AL (03) 002	Scale 1:50
Rev. A	Date Sept. '21